

VOLO.
Freedom to fly

Lip Light

Mmm

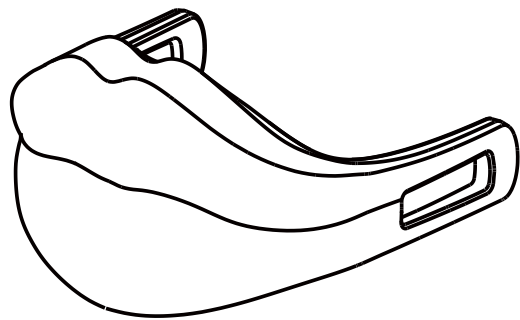

FITMENT CHECK

WORKING TIME

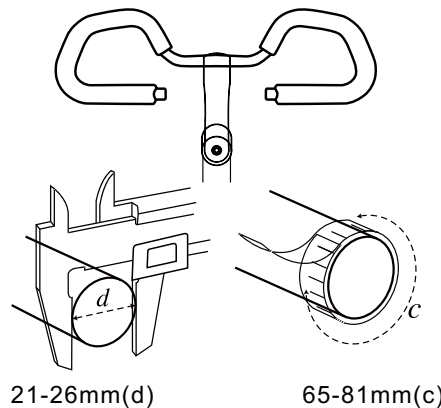

21-26mm(d)

65-81mm(c)

PARTS

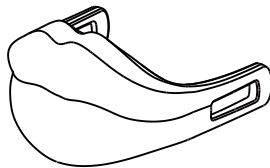

Color:

FEATURES

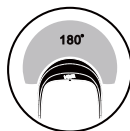

POWER: 250mA lithium battery

MATERIAL: Engineering grade Plastic & Silicone

FUNCTION: Permanent- Fast flashing- Slow flashing-Breathing

Mmm	Red	Orange	Yellow	Green	Pink
 Slow Flashing	8:20 h:min	12:40 h:min	12:30 h:min	13:00 h:min	11:00 h:min
 Fast Flashing	8:25 h:min	12:50 h:min	12:50 h:min	13:10 h:min	10:50 h:min
 Breathing	8:20 h:min	12:35 h:min	12:40 h:min	13:00 h:min	10:40 h:min
 Permanent	4:20 h:min	6:30 h:min	6:30 h:min	6:30 h:min	5:30 h:min

VOLO BIKE PRODUCTS LIMITED
<http://www.volo.com.hk>

Phone: +86 755 29558017
Fax: +86 755 22631887
E-mail: sales@volo.com.hk

VOLO freedom to fly
 VOLO bike



Design by VOLO
Made in china



INSTALLATION AND USE

⚠ Always charge the product before use

To charge a device :

Connect the device's charge cable to the female USB port on the front of the PWR Bank.

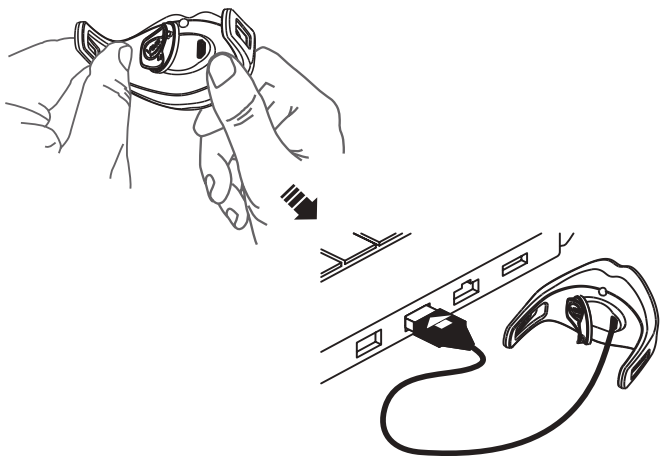

Before using your VOLO LIP LIGHT for the first time, fully charge battery.

1. Turn OFF the light
2. Remove USB Protective Cover
3. Connect micro USB cable and light to powered USB port
4. Once charging, button will be on red. Light will be charged after 3-4 hours or when button turn green.
5. Remove light from Charger and reinstall USB protective cover, ensure USB protective cover is fully installed for water resistance.

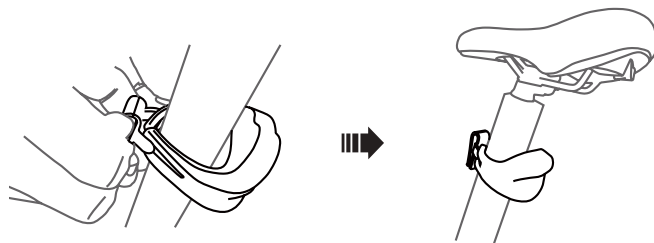

PRODUCT USE

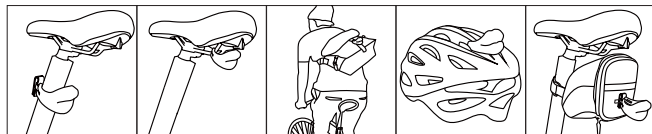

SWITCH OPERATION

4 Modes: Permanent/Fast Flashing/Slow Flashing/
Breathing;
Easy to install & release, Rechargeable Lithium Battery,
Soft light for people's visual safe

